

TYPICAL DETAIL A-A - THICKENING BEAM

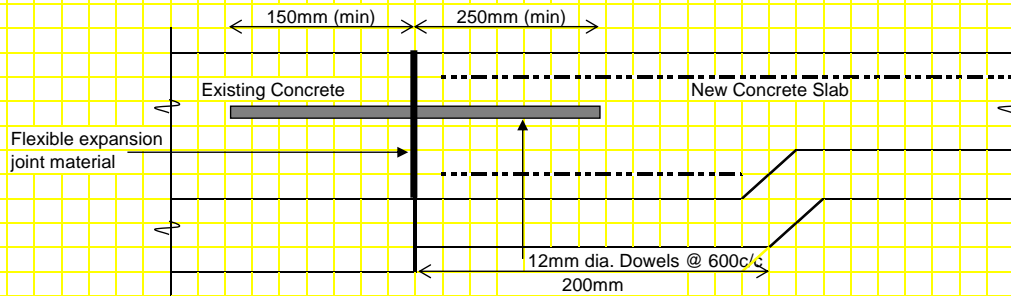

TYPICAL DETAIL B-B - DOWELLED JOINT TO EXISTING SLABS AND PATHS

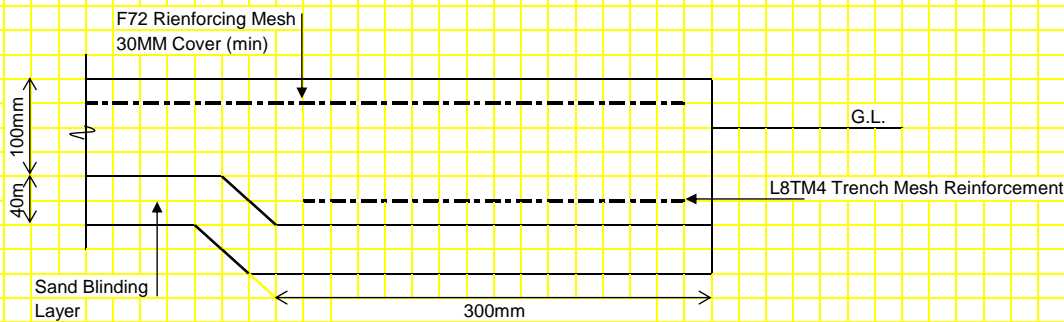

TYPICAL DETAIL C-C - EDGE BEAM

NOTES:

- 1) The existing river gravel and slate stepping stones to be removed and stored at depot or as directed
- 2) Excavate to required levels
- 3) The existing compacted base will require a sand blinding layer of minimum 40mm thickness levelled to required levels
- 4) Install a polythene plastic membrane minimum 200um with laps of 150mm and all joints taped between new concrete and sand blinding layer
- 5) Saw cuts shall be suitable as construction joints placed at 3m intervals in each direction
- 6) Key joints shall be installed at the end of a pour if pouring of concrete is to be scheduled over a period of days
- 7) Concrete to be steel trowelled finish to a non-slip surface. An option for alternate surface finish shall be supplied e.g. coloured textured finish

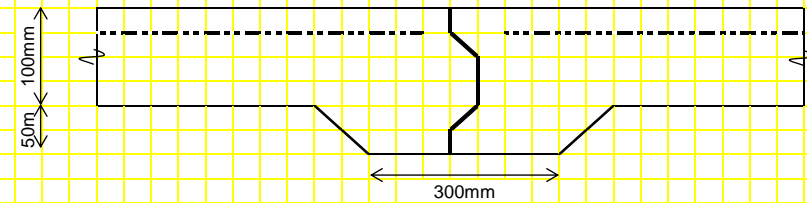

TYPICAL DETAIL - KEY JOINTS

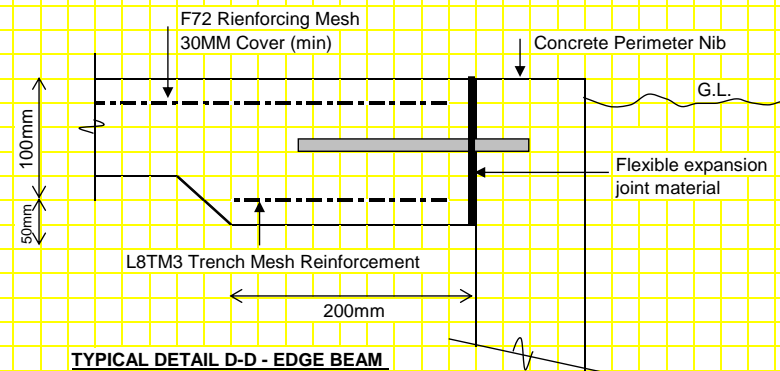

TYPICAL DETAIL D-D - EDGE BEAM TO PERIMETER CONCRETE NIB

**** DIMENSIONS ON THESE DETAILS ARE NOT TO SCALE**



PROJECT:
PROPOSED INSTALLATION OF NEW CONCRETE SLAB

LOCATION:
GEORGETOWN TERRESTRIAL CENTRE

Job Number:
DETAILS

Prepared By:
PLG

Date:
7 May 2014

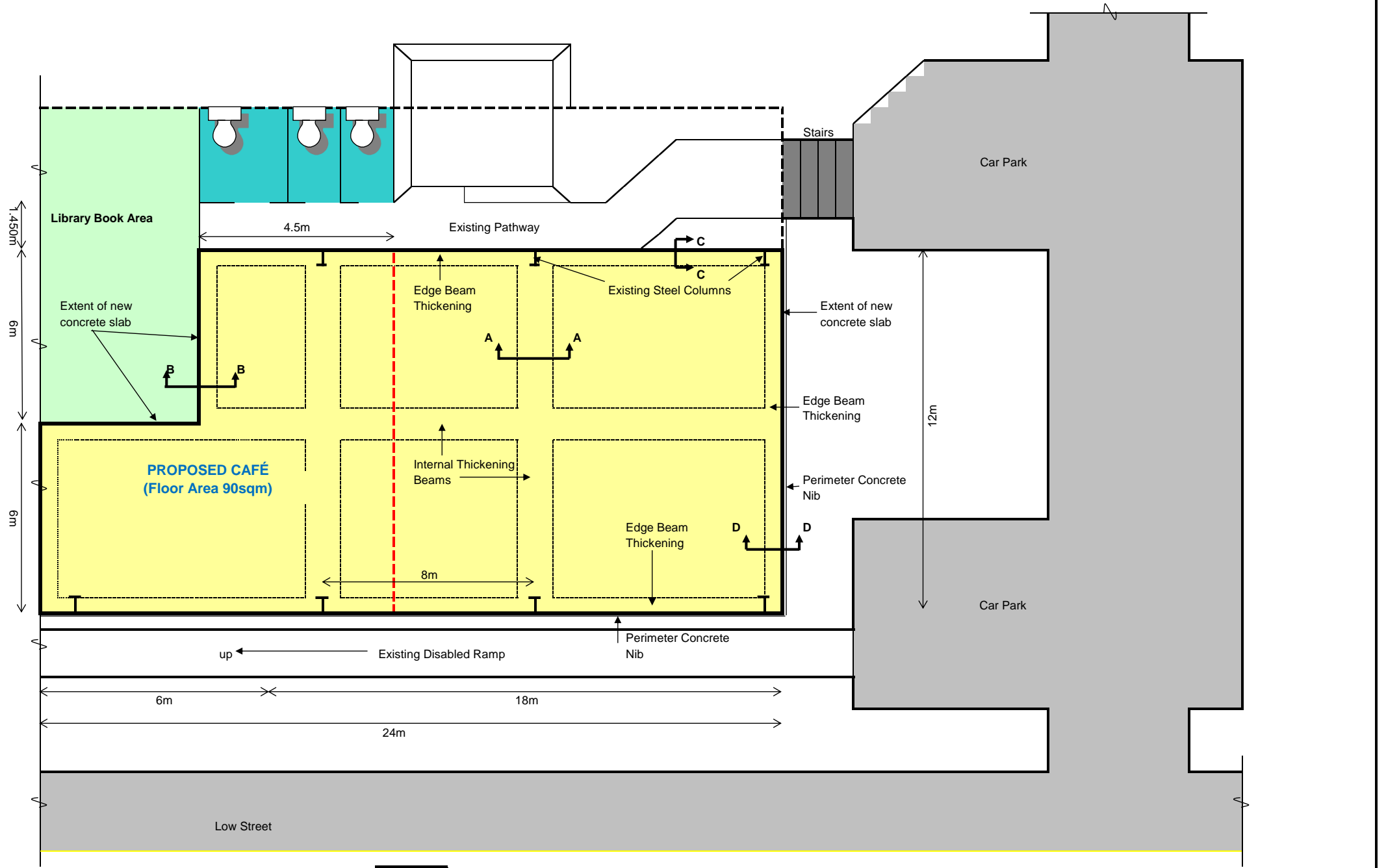

- Notes:**
- Excavate existing loose river gravel and stepping stones and store as directed
 - Excavate entire area to required levels including sections of access path to toilets
 - Concrete to be 25mPa generally 100mm thick with allowances for edge and thickening beams
 - Dowelled joints to be incorporated at all junctions to existing concrete including perimeter concrete nib and paths
 - Key joints shall be installed at any breaks in concrete pour
 - Non slip steel trowed finish to entire surface of new slab

Extent of New Concrete



PROJECT: PROPOSED INSTALLATION OF NEW CONCRETE SLAB
LOCATION: TERRESTRIAL BUILDING GEORGETOWN

Job Number: PLAN: SLAB DETAIL
Prepared By: PLG
Date: 7 May 2014