

Agricultural Potential of the Gilbert River Area
Chadshunt to Mount Sircom

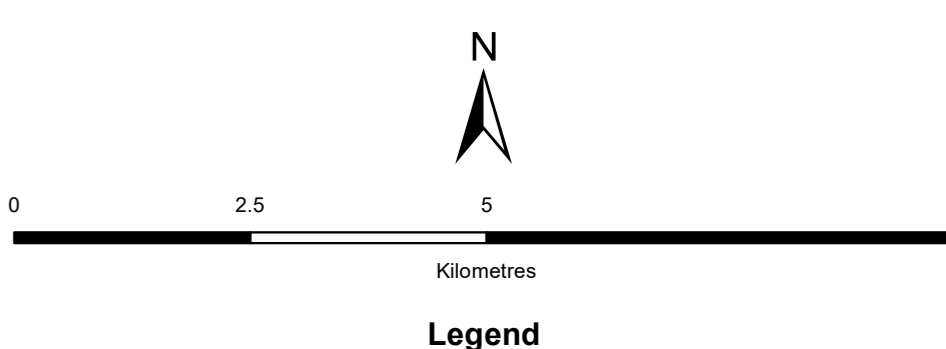

- Legend**
- Homestead
 - Watercourses
 - Old Roads
 - Gilbert River Agricultural Potential Properties
 - ▭ Arable land, land suitable for a wide range of irrigated land uses with negligible to minor limitations (20 984 ha)
 - ▭ Arable land, land suitable for a range of irrigated land uses due to moderate limitations (7 580 ha)

Arable land mapping extracted from the Gilbert River Irrigation Area Investment Report 2nd Edition - July 2014

Horizontal Datum: Geocentric Datum of Australia 1994 (GDA94)
Projection: Geographical

Disclaimer:
While every care is taken to ensure the accuracy of this product, the State of Queensland (Department of Natural Resources and Mines) 2017 and AgForce Queensland make no representations or warranties about its accuracy, reliability, completeness or suitability for any particular purpose and disclaims all responsibility and all liability (including without limitation, liability in negligence) for all expenses, losses, damages (including indirect or consequential damage) and costs which you might incur as a result of the product being inaccurate or incomplete in any way and for any reason.

Produced by AgForce Queensland 10 August 2017

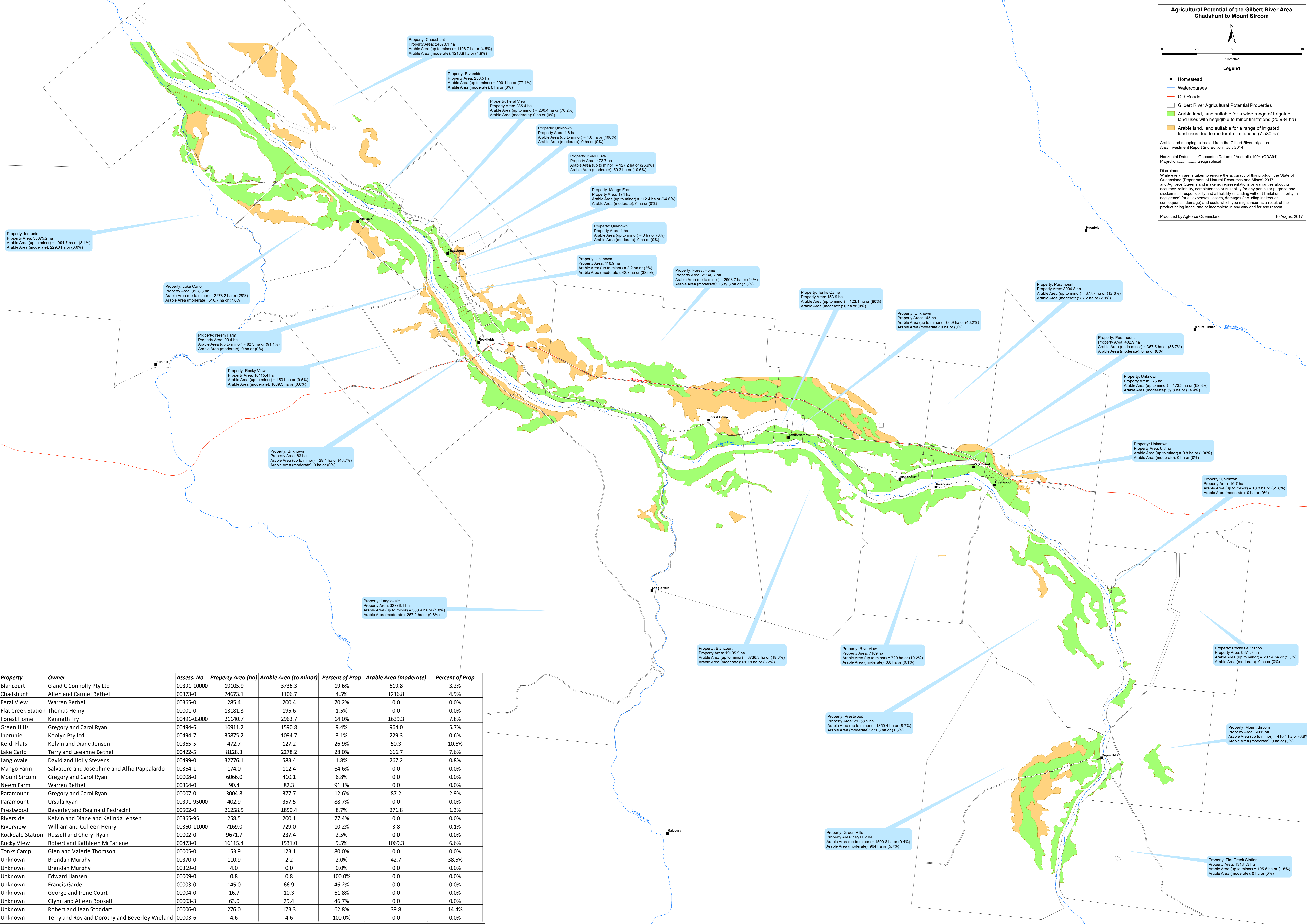

Property	Owner	Assess. No	Property Area (ha)	Arable Area (to minor)	Percent of Prop	Arable Area (moderate)	Percent of Prop
Blancourt	G and C Connolly Pty Ltd	00391-10000	19105.9	3736.3	19.6%	619.8	3.2%
Chadshunt	Allen and Carmel Bethel	00373-0	24673.1	1106.7	4.5%	1216.8	4.9%
Feral View	Warren Bethel	00365-0	285.4	200.4	70.2%	0.0	0.0%
Flat Creek Station	Thomas Henry	00001-0	13181.3	195.6	1.5%	0.0	0.0%
Forest Home	Kenneth Fry	00491-05000	21140.7	2963.7	14.0%	1639.3	7.8%
Green Hills	Gregory and Carol Ryan	00494-6	16911.2	1590.8	9.4%	964.0	5.7%
Inorunie	Koolyn Pty Ltd	00494-7	35875.2	1094.7	3.1%	229.3	0.6%
Keldi Flats	Kelvin and Diane Jensen	00365-5	472.7	127.2	26.9%	50.3	10.6%
Lake Carlo	Terry and Leeanne Bethel	00422-5	8128.3	2278.2	28.0%	616.7	7.6%
Langlovale	David and Holly Stevens	00499-0	32776.1	583.4	1.8%	267.2	0.8%
Mango Farm	Salvatore and Josephine and Alfio Pappalardo	00364-1	174.0	112.4	64.6%	0.0	0.0%
Mount Sircom	Gregory and Carol Ryan	00008-0	6066.0	410.1	6.8%	0.0	0.0%
Neem Farm	Warren Bethel	00364-0	90.4	82.3	91.1%	0.0	0.0%
Paramount	Gregory and Carol Ryan	00007-0	3004.8	377.7	12.6%	87.2	2.9%
Paramount	Ursula Ryan	00391-95000	402.9	357.5	88.7%	0.0	0.0%
Prestwood	Beverley and Reginald Pedracini	00502-0	21258.5	1850.4	8.7%	271.8	1.3%
Riverside	Kelvin and Diane and Kelinda Jensen	00365-95	258.5	200.1	77.4%	0.0	0.0%
Riverview	William and Colleen Henry	00360-11000	7169.0	729.0	10.2%	3.8	0.1%
Rockdale Station	Russell and Cheryl Ryan	00002-0	9671.7	237.4	2.5%	0.0	0.0%
Rocky View	Robert and Kathleen McFarlane	00473-0	16115.4	1531.0	9.5%	1069.3	6.6%
Tonks Camp	Glen and Valerie Thomson	00005-0	153.9	123.1	80.0%	0.0	0.0%
Unknown	Brendan Murphy	00370-0	110.9	2.2	2.0%	42.7	38.5%
Unknown	Brendan Murphy	00369-0	4.0	0.0	0.0%	0.0	0.0%
Unknown	Edward Hansen	00009-0	0.8	0.8	100.0%	0.0	0.0%
Unknown	Francis Garde	00003-0	145.0	66.9	46.2%	0.0	0.0%
Unknown	George and Irene Court	00004-0	16.7	10.3	61.8%	0.0	0.0%
Unknown	Glynn and Aileen Bookall	00003-3	63.0	29.4	46.7%	0.0	0.0%
Unknown	Robert and Jean Stoddart	00006-0	276.0	173.3	62.8%	39.8	14.4%
Unknown	Terry and Roy and Dorothy and Beverley Wieland	00003-6	4.6	4.6	100.0%	0.0	0.0%

Property: Mount Sircom
Property Area: 6066 ha
Arable Area (up to minor) = 410.1 ha or (6.8%)
Arable Area (moderate): 0 ha or (0%)

Property: Flat Creek Station
Property Area: 13181.3 ha
Arable Area (up to minor) = 195.6 ha or (1.5%)
Arable Area (moderate): 0 ha or (0%)